

LIVEN LVH Series

AGM (Absorbent Glass Material) technology with gas recombination. The LVH series Valve Regulated Lead Acid (VRLA) battery is designed for heavy load discharge applications with 15 years design life in float service. By using strong grids and specially designed active material is with lower I.R, lower self discharge rate, high power, and longer service life performance. Generally the LVH series offers 30% more power output than the standard range.

Application:

- High Power
- Uninterrupted Power Supplies
- Datacenters
- Emergency backup power supply
- Alarm and security system
- Communication power supply
- DC power supply
- Electric Tools

Dimensions:

Length	350±1mm (13.8 inches)
Width	167±1mm (6.57 inches)
Height	182±1mm (7.17 inches)
Total Height	182±1mm (7.17 inches)

Drawing:

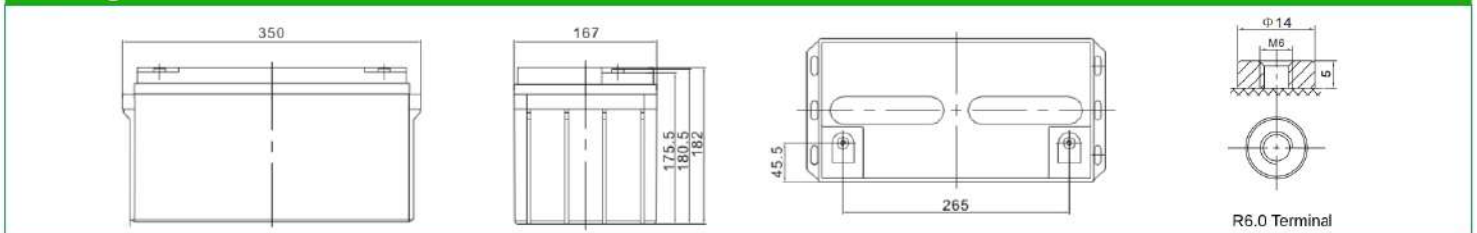

Specification:

Cells Per Unit	6
Voltage Per Unit	12
Nominal Capacity	240W@15min-rate to 1.67V per cell @25°C
Weight	Approx. 19.5 Kg ±2%
Internal Resistance	Approx. 6.5 mΩ
Terminal	R6.0
Max. Discharge Current	650A (5 sec)
Design Life	15 years floating Eurobat (20°C): >12 years Very Long Life
Recommended Maximum Charging Current	19.5 A
Reference Capacity	C20 65.0AH
Standby Use Voltage	13.6 V~13.8 V @ 25°C Temperature Compensation: -3mV/°C/Cell
Cycle Use Voltage	14.6 V~14.8 V @ 25°C Temperature Compensation: -4mV/°C/Cell
Operating Temperature Range	Discharge: -15°C~50°C Charge: -10°C~45°C Storage: -15°C~50°C
Normal Operating Temperature Range	25°C±5°C
Self Discharge	LIVEN Valve Regulated Lead Acid (VRLA) batteries can be stored for up to 6 months at 25°C and then recharging is recommended. Monthly Self-discharge ratio is less than 3% at 25°C. Please charge batteries before using.
Container Material	A.B.S. UL94-HB, UL94-V0 Optional.



Constant Current Discharge (CC, Unit: A) at 25°C (77°F)

F.V/Time	5MIN	8MIN	10MIN	15MIN	20MIN	30MIN	60MIN	90MIN
1.60V	239.8	198.6	174.0	132.7	108.1	79.7	46.1	33.1
1.67V	217.6	182.1	160.8	123.8	101.6	75.4	44.0	31.7
1.70V	208.4	175.0	155.0	120.0	98.7	73.6	43.1	31.1
1.75V	192.4	163.0	145.3	113.5	93.8	70.5	41.6	30.1
1.80V	176.3	151.0	135.6	107.4	89.4	67.5	40.1	29.2
1.85V	151.3	128.6	114.9	92.4	77.6	59.7	36.2	26.6

Constant Power Discharge (CP, Unit: W/Battery) at 25°C (77°F)

F.V/Time	5MIN	8MIN	10MIN	15MIN	20MIN	30MIN	60MIN	90MIN
1.60V	2644.2	2218.8	1963.2	1518.0	1246.2	928.8	519.6	375.6
1.67V	2461.2	2081.4	1852.8	1440.0	1189.8	890.4	499.8	363.0
1.70V	2380.2	2019.0	1801.2	1406.4	1164.0	872.4	492.0	358.2
1.75V	2233.8	1908.0	1710.6	1345.8	1117.2	843.6	478.2	348.6
1.80V	2079.0	1791.0	1615.2	1285.8	1075.2	814.2	463.8	339.0
1.85V	1810.8	1546.8	1387.2	1117.8	942.0	726.6	421.8	312.0

Discharge Characteristics Curve

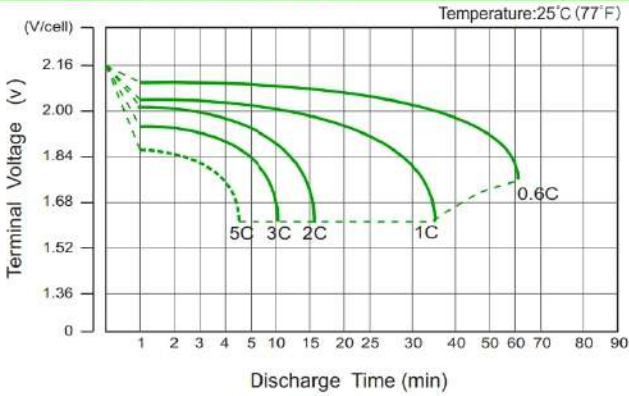

Charge Characteristic Curve For Standby Use

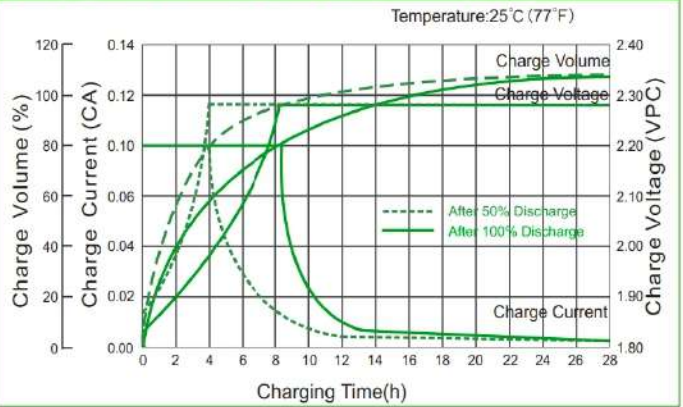

Cycle Life In Relation To Depth Of Discharge

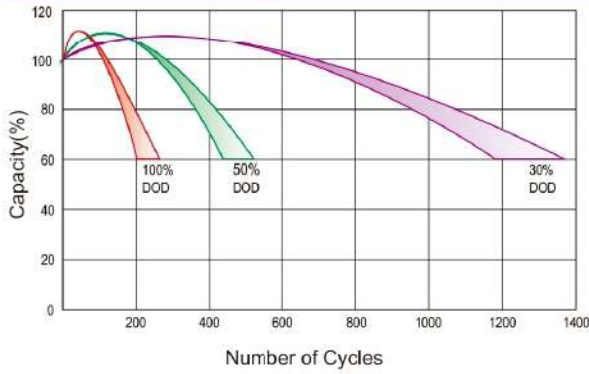

Relationship Between Charging Voltage And Temperature

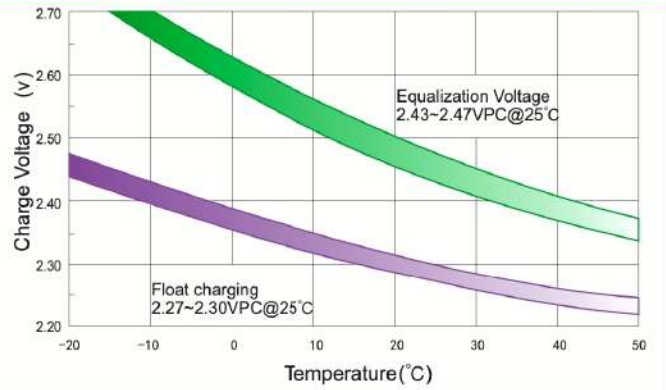

Temperature Effects On Capacity

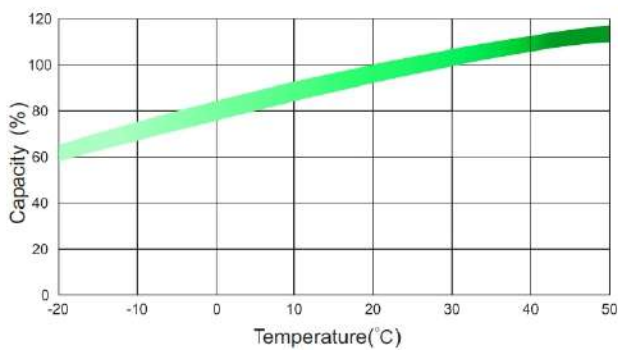

Storage Characteristics

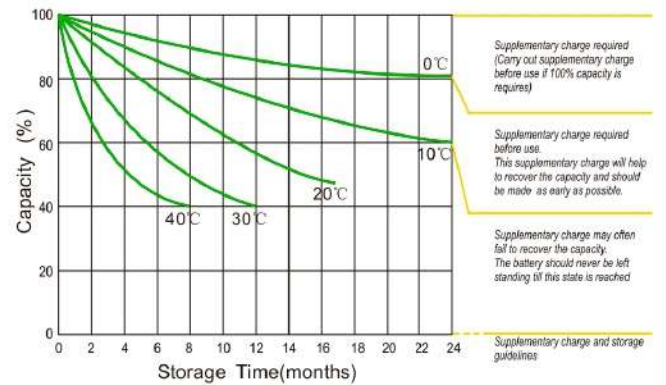

Effect Of Temperature On Long Term Life

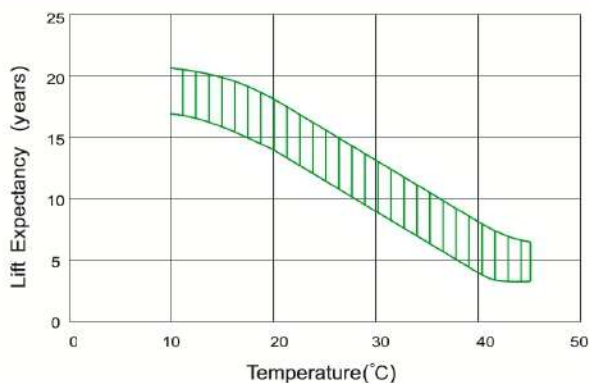

Life Characteristics Of Standby Use

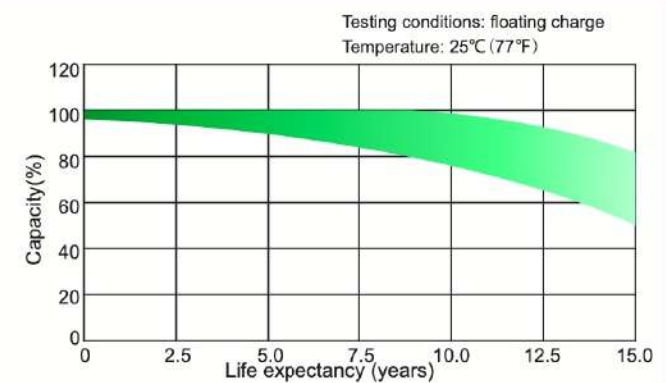

(Note) All above information shall be changed without prior notice, LIVEN Battery reserves the right to explain and update the latest information.