



### LIVEN LVH Series

AGM (Absorbent Glass Material) technology with gas recombination. The LVH series Valve Regulated Lead Acid (VRLA) battery is designed for heavy load discharge applications with 15 years design life in float service.

By using strong grids and specially designed active material is with lower I.R, lower self discharge rate, high power, and longer service life performance.

Generally the LVH series offers 30% more power output than the standard range.

### Applications:

- High Power
- UPS
- Datacenters
- Emergency backup PW
- Security system
- Communication power supply
- DC power supply
- Electric Tools

### Dimensions:

Length	483±2mm (19.0in)
Width	170±2mm (6.69in)
Height	241±2mm (9.49in)
Total Height	241±2mm (9.49in)

### Specifications:

Cells Per Unit	6
Voltage Per Unit	12V
Nominal Capacity	570W @15min-rate to 1.67V per cell @25°C
Weight	Approx. 46.0Kg ±2% (101.41lbs)
Internal Resistance	Approx. 3.8mΩ
Terminal	R8.0
Max. Discharge Current	1500A (5sec)
Design Life	15 years floating Eurobat (20°C): >12 years Very Long Life
Recommended Maximum Charging Current	45.0A
Reference Capacity	C20 150Ah
Standby Use Voltage	13.6V~13.8V @ 25°C Temperature Compensation: -3mV/°C/Cell
Cycle Use Voltage	14.6V~14.8V @ 25°C Temperature Compensation: -4mV/°C/Cell
Operating Temperature Range	Discharge: -15°C~50°C Charge: -10°C~45°C Storage: -15°C~50°C
Normal Operating Temperature Range	25°C±5°C

### Self Discharge

LIVEN Valve Regulated Lead Acid (VRLA) batteries can be stored for up to 6 months at 25°C and then recharging is recommended. Monthly Self-discharge ratio is less than 3% at 25°C. Please charge batteries before using.

### Container Material

A.B.S. UL94-HB, UL94-V0 Optional.

### Technical Drawings:

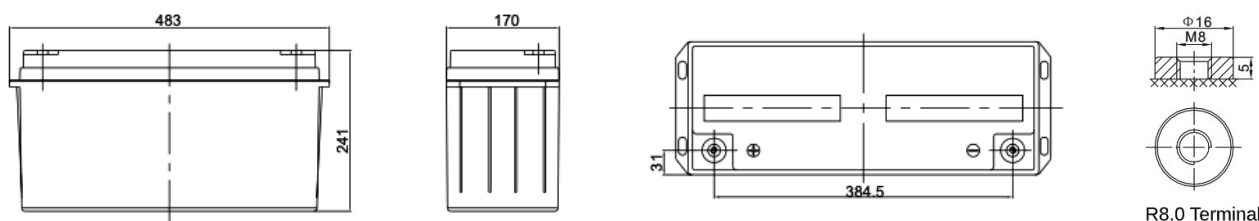

### Constant Current Discharge (CC, Unit: A) at 25°C (77°F)

F.V./ Time	5min	8min	10min	15min	20min	30min	60min	90min
1.60V	467.1	414.9	384.2	315.2	256.7	189.2	109.5	78.6
1.67V	423.8	380.5	355.1	293.9	241.3	179.0	104.4	75.4
1.70V	405.8	365.7	342.3	285.0	234.5	174.7	102.4	73.9
1.75V	374.7	340.7	320.9	269.6	222.8	167.3	98.8	71.6
1.80V	343.3	315.5	299.5	255.1	212.3	160.2	95.2	69.3
1.85V	294.6	268.8	253.8	219.4	184.3	141.7	86.0	63.1

### Constant Power Discharge (CP, Unit: W/Battery) at 25°C (77°F)

F.V./ Time	5min	8min	10min	15min	20min	30min	60min	90min
1.60V	5149.2	4636.2	4336.2	3604.8	2959.8	2205.6	1233.6	892.2
1.67V	4792.8	4349.4	4092.0	3420.0	2824.8	2115.0	1187.4	862.8
1.70V	4635.0	4219.2	3978.0	3340.8	2763.6	2072.4	1167.6	850.2
1.75V	4349.4	3987.0	3778.2	3196.2	2652.6	2004.0	1135.8	827.4
1.80V	4048.2	3742.8	3567.6	3054.0	2553.0	1933.8	1102.2	804.6
1.85V	3526.2	3232.8	3063.0	2655.0	2236.8	1725.0	1002.0	740.4

Discharge Characteristics Curve

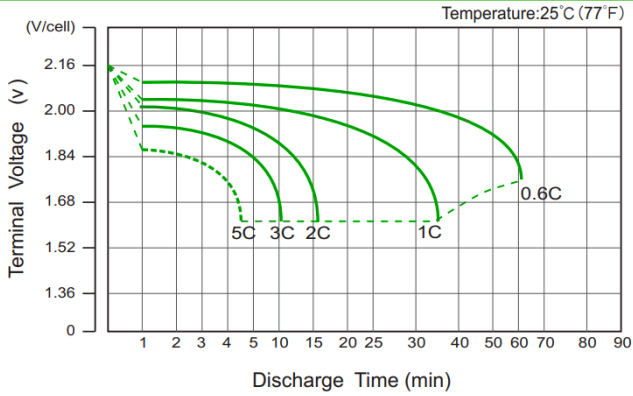

Charge Characteristic Curve For Standby Use

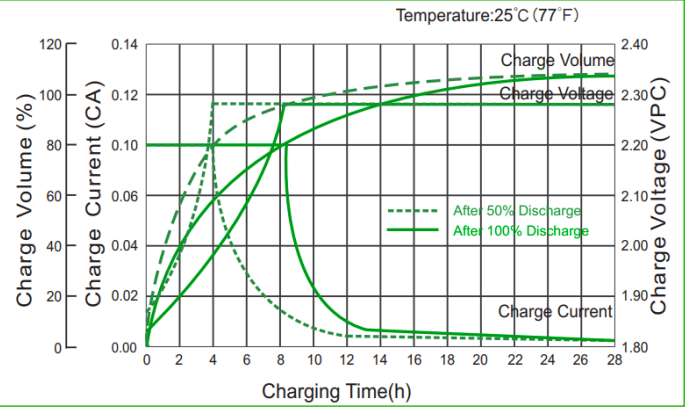

Cycle Life In Relation To Depth Of Discharge

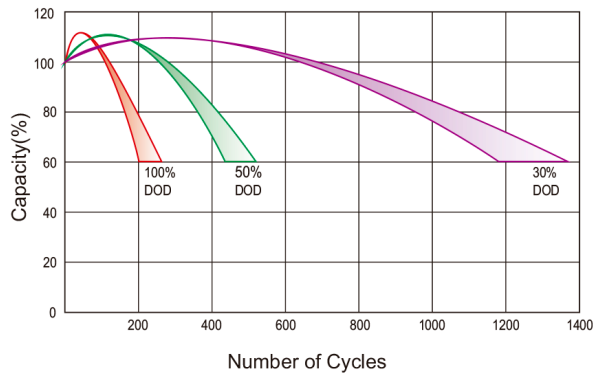

Relationship Between Charging Voltage And Temperature

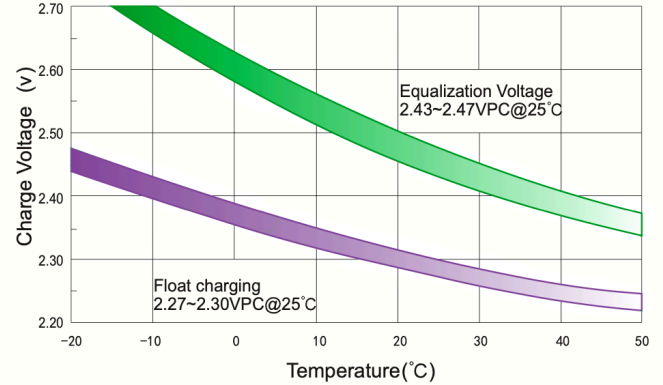

Temperature Effects On Capacity

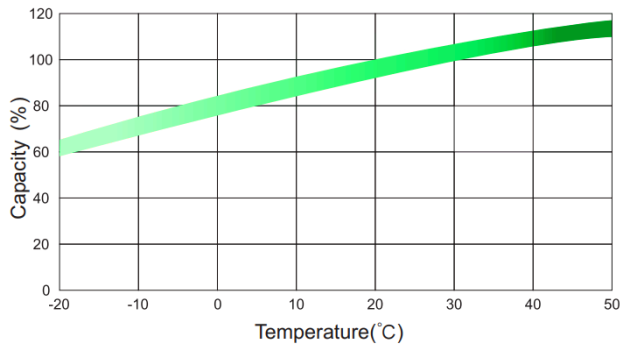

Storage Characteristics

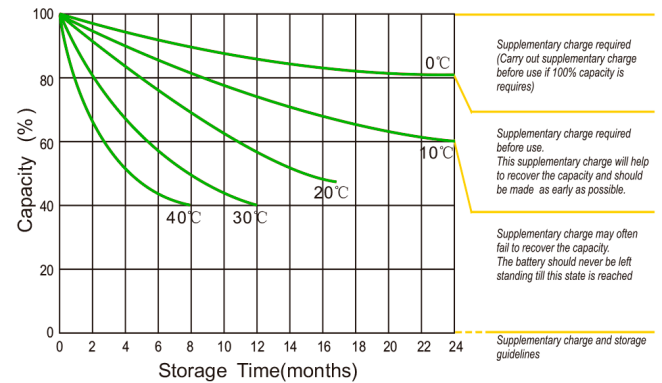

Effect Of Temperature On Long Term Life

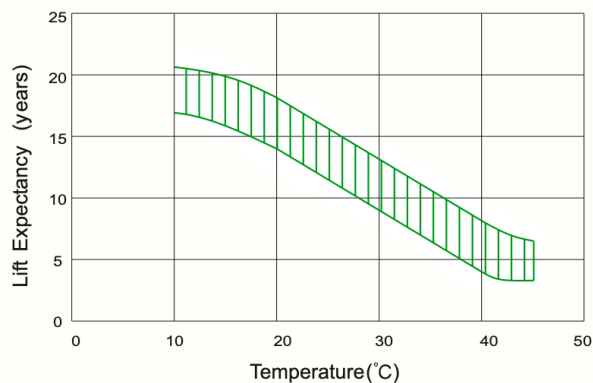

Life Characteristics Of Standby Use

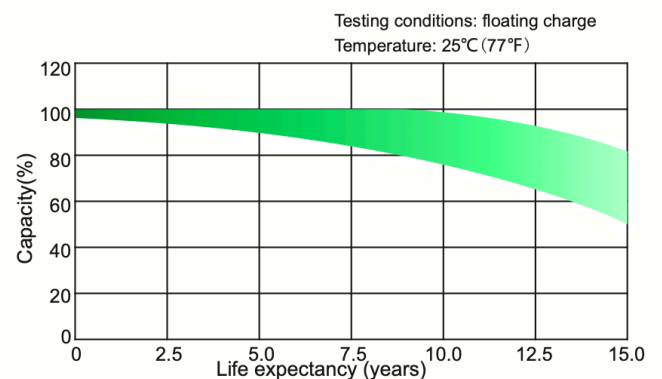

(Note) All above information shall be changed without prior notice, LIVEN Battery reserves the right to explain and update the latest information.