



LIVEN LVIF Series-LiFePO₄

- > High performance, completely maintenance-free, low self-discharge
- > Floating & standby use: up to 10 years
- > 100% precise quality testing, stable quality and high reliable performance
- > Uniform output voltage in all the discharge curve
- > Provide full nominal capacity, even at high currents
- > Energy density: up to 130Wh/kg
- > Capacity density: up to 145Ah/kg
- > Suitable for standby power and energy storage power use
- > Long storage time
- > Cycle use: Up to 2000 cycles at 100% DOD

Application:

- > Telecommunications
- > Uninterruptable Power Supply (UPS)
- > DC power supply
- > Electric Power System (EPS)
- > Emergency backup power supply
- > Wheelchairs and Scooters
- > Golf trolleys and Golf cart
- > Railway and Marine systems
- > Electric tools
- > Medical equipments

Specification:

NOMINAL VOLTAGE		3.2 V
NOMINAL CAPACITY (0.2C, 25°C, current value of 3600mAh at 1C)		3600±2mAh
MINIMUM CAPACITY (0.2C, 25°C)		3350mAh
DISCHARGE	NORMAL CURRENT	≤1.8A
	FAST DISCHARGE CURRENT	3.6A
	MAX CONTINUOUS CURRENT	10.8A (@ 5min)
	MAX PEAK CURRENT	20A (@ 5sec)
	CUT-OFF VOLTAGE	2.5±0.2V
CHARGE	CHARGE VOLTAGE	3.65±0.05V
	CHARGE CURRENT	≤ 3.6A
	CUT-OFF CURRENT	0.01C
	CHARGE MODE	CC/CV, use special Lithium LFP Charger
INNER RESISTANCE	DISCHARGING INNER RESISTANCE	≤ 25mΩ
OPERATION TEMPERATURE RANGE <i>(When the environment temperature is higher than 45°C, please pay attention to ventilation and heat rejection)</i>	CHARGE	0°C~+55°C
	DISCHARGE	-20°C~+60°C
STORAGE TEMPERATURE RANGE (Capacity 80%) <i>(Recommended long term storage temperature is 15~25°C)</i>		-20°C~ +45°C
HUMIDITY RANGE <i>(When the environment temperature is higher than 45°C, please pay attention to ventilation and heat rejection)</i>	CHARGE-DISCHARGE	RH= 85%, When the environment humidity is higher than 85%, please pay attention to protect.
	STORAGE	RH= 50%, Easily oxidized components note sealed.
DIMENSIONS (LxWxH) (mm)		26.20±0.1mm x 26.20±0.1mm x 65.6±0.3mm
WEIGHT (kg)		85.0 ±0.1g
CYCLE		2000 times (100% DOD)
		4000 times (80% DOD)
		7000 times (50% DOD)

Drawing:

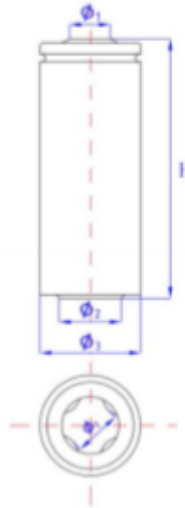

Cell feature Curves at 25°C (77°F)

Charge-Discharge characteristic Curve

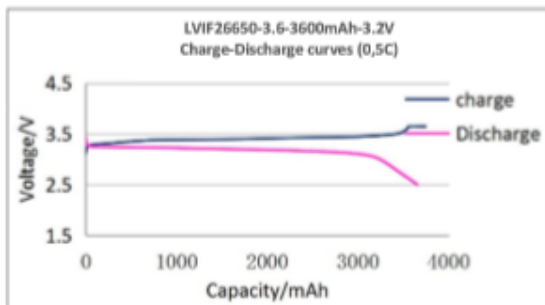

Discharge characteristic Curves

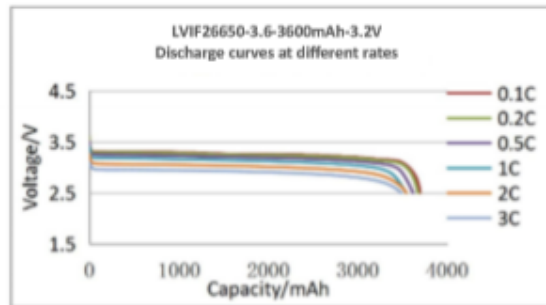

Discharge Curves at different Temperatures

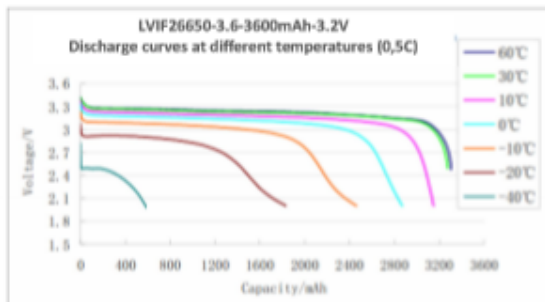

Life characteristics of cyclic use

